



# INSTRUCTION BULLETIN

No. 340249  
Machine: 6200  
Published: 12-99/01  
System: OPTIONS

**NOTE: DO NOT DISCARD the Parts List from the Instruction Bulletin. Place the Parts List in the appropriate place in your machine manual for future reference. Retaining the Parts List will make it easier to reorder individual parts and will save you the cost of ordering an entire kit.**

*NOTE: Numbers in parenthesis ( ) are reference numbers for parts listed in Bill of Materials.*

Installation instructions for kit number 384127 and 384129

## **SYNOPSIS / PROBLEM:**

This kit contains the parts needed to install 36V light kits on the model 6200 sweeper.  
Please follow step-by-step instructions.

## **SPECIAL TOOLS / CONSIDERATIONS: NONE**

(Estimated time to complete: 1 hour)

## **PREPARATION:**

(Refer to FIG. 1, 2 and 3)

**FOR SAFETY: Before leaving or servicing machine, stop on level surface and set parking brake. Then turn off machine and remove key.**

1. Disconnect battery cables from machine.



**WARNING: Always disconnect battery cables from machine before working on electrical components.**

## **INSTALLATION:**

(Refer to FIG. 1, 2 and 3)

*NOTE: If your machine is already equipped with the operating headlight / taillight package, proceed to step number 5. Keep switch 360520 and circuit breaker 383722 as spare parts.*

1. Open the circuit breaker panel.
2. Install the new circuit breaker (11) in the panel. Wire the circuit breaker (11) into the main harness. (Refer to FIG. 1, 2 and 3)
3. Remove the standard light switch in the control panel, and unplug it from the wiring harness. (Refer to FIG. 1, 2 and 3)
4. Plug the new switch (12) into the wiring harness, and snap it into place in the control panel. (Refer to FIG. 1, 2 and 3)
5. Check that the grommet (7) is secured in the light mounting plate (5). (Refer to FIG. 1 and 2)
6. Run the light wiring connections through the grommet in the mounting plate, and connect the light (1) to the light harness (10). Connect the light harness (10) to the main wiring harness. (Refer to FIG. 1, 2 and 3)

7. Assemble the light (1) and mounting plate (5) to the machine, with hex screws (6) and flat washers (4). (Refer to FIG. 1 and 2)
8. Bundle any excess harness (10) with the cable tie (9) and adhere to the machine with the cable tie mount (8). (Refer to FIG. 1 and 2)
9. Turn the machine power on, and check warning light (1) for proper operation.
10. Mount the lamp guard (2) to the mounting plate (5) with four hex screws (3) and washers(4). (Refer to FIG. 1 and 2)

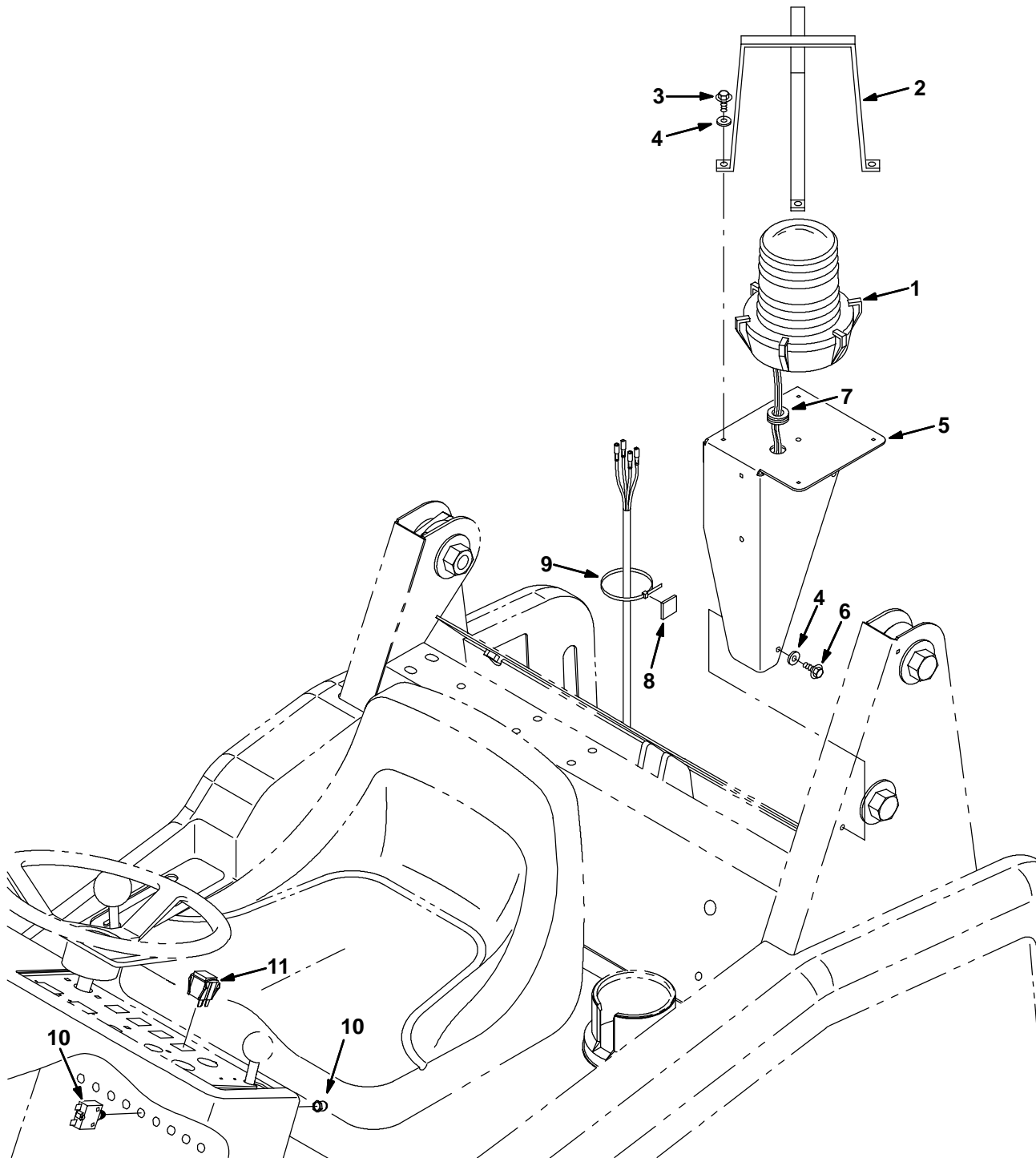

**FIG. 1 - INSTALLATION OF FLASHING LIGHT KIT 384127**

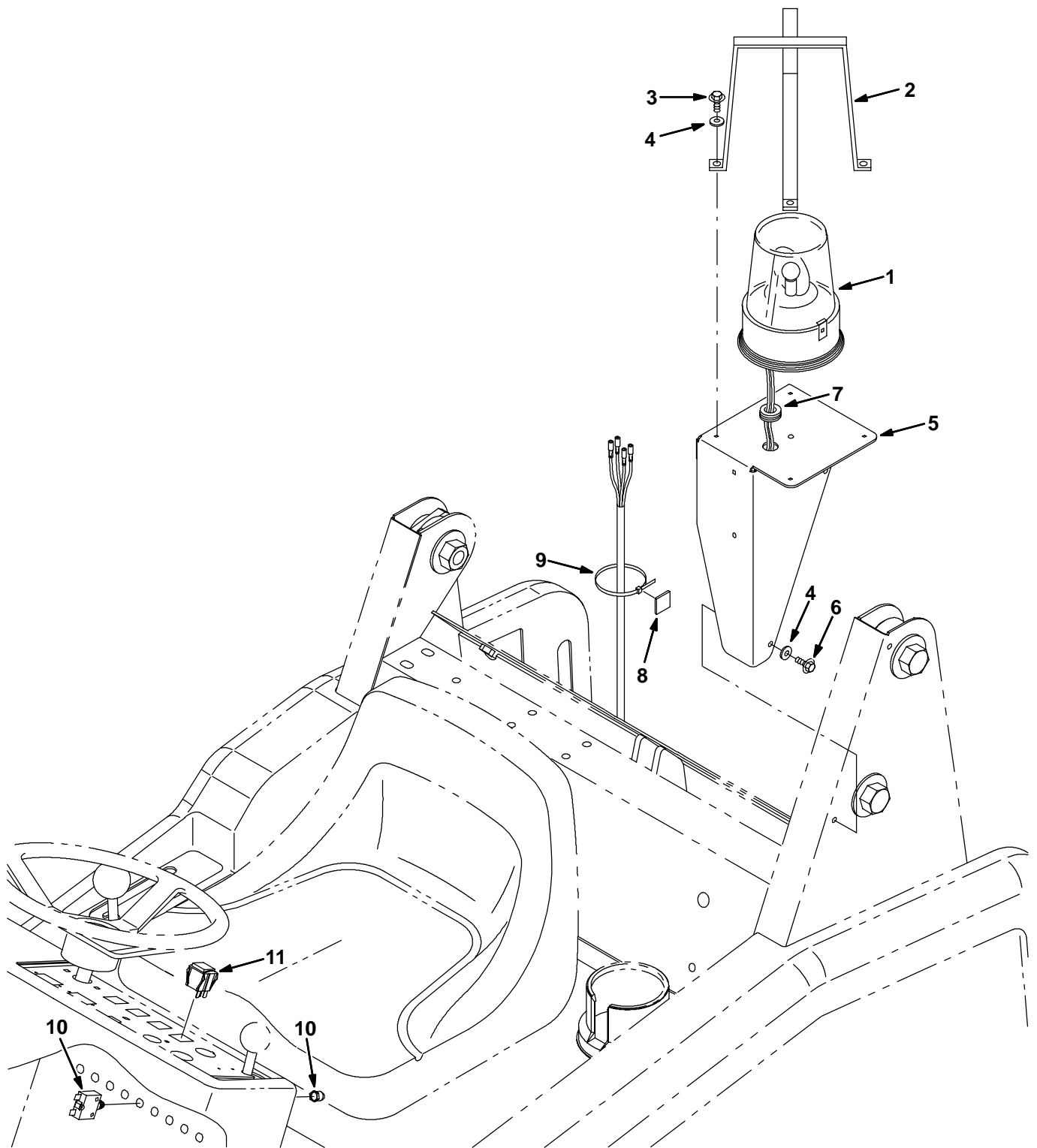

**FIG. 2 - INSTALLATION OF REVOLVING LIGHT KIT 384129**

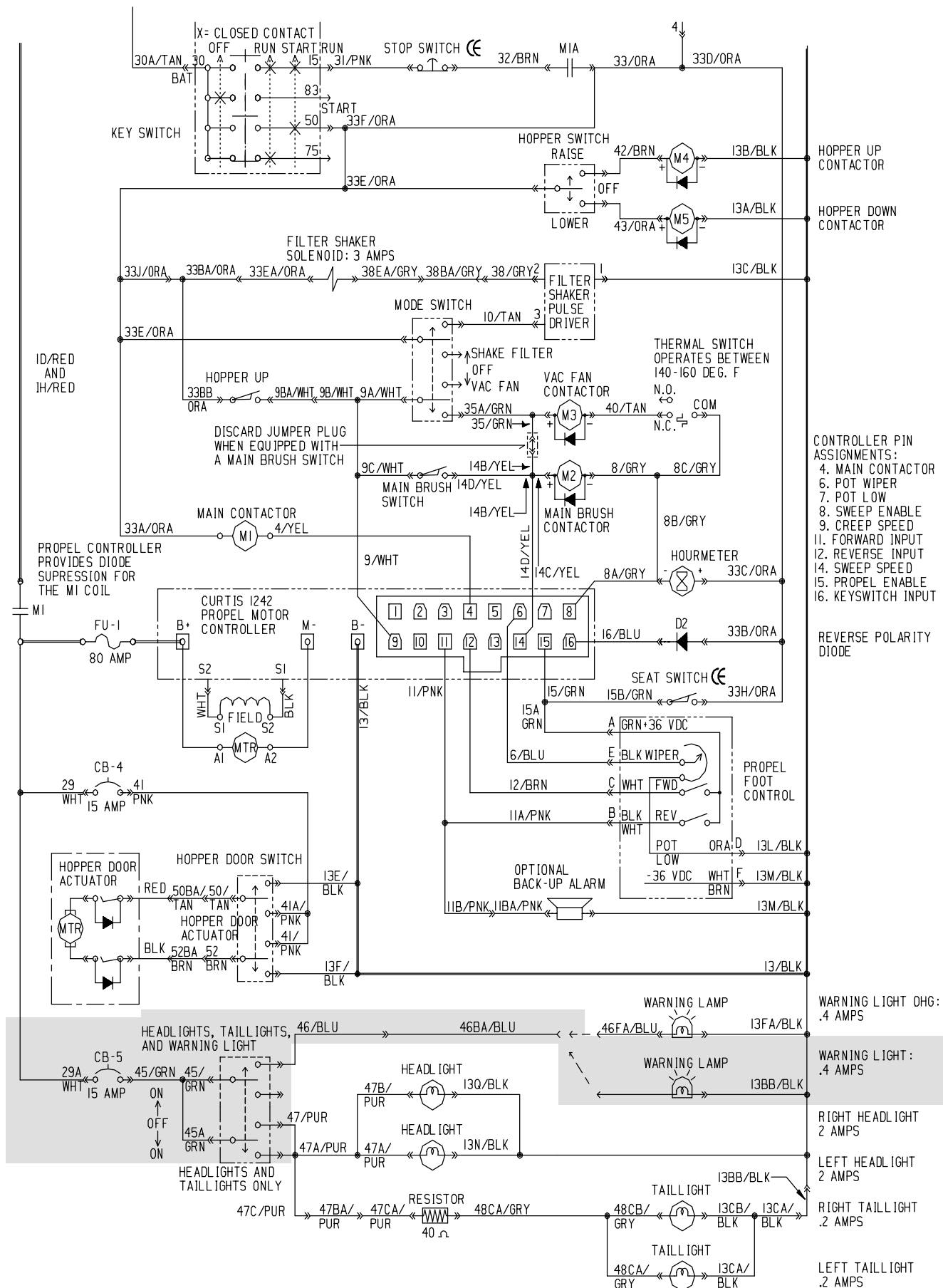

**FIG. 3 - 6200 ELECTRICAL SCHEMATIC**

# **BILL OF MATERIALS FOR FLASHING LIGHT KIT 384127**

<b>Ref.</b>	<b>TENNANT Part No.</b>	<b>Description</b>	<b>Qty.</b>
▲ 1	383975	Lamp, Revl, Amb, 36Vdc Rework	1
▲ 2	45272	Guard, Lamp	1
▲ 3	12459	Screw, Hex, Fmg, M06-1.0 X 20	4
▲ 4	32490	Washer, Flat, .25 Hard	6
▲ 5	384165	Angle, Mtg, Light	1
▲ 6	361339	Screw, Hex 6X 1.0 16 Pltd	2
▲ 7	10632-2	Grommet, Rubber	1
▲ 8	55248	Mount, Cable Tie	1
▲ 9	49266	Tie, Cable 1.75D Max 7.50Lg	1
▲ 10	383722	Circuitbreaker, 15Amp	1
▲ 11	360520	Switch, Rocker, Spdt, 3Pos	1

# **BILL OF MATERIALS FOR REVOLVING LIGHT KIT 384129**

<b>Ref.</b>	<b>TENNANT Part No.</b>	<b>Description</b>	<b>Qty.</b>
▲ 1	383976	Lamp, Revl, Amb, 36Vdc Rework	1
▲ 2	45272	Guard, Lamp	1
▲ 3	12459	Screw, Hex, Fmg, M06-1.0 X 20	4
▲ 4	32490	Washer, Flat, .25 Hard	6
▲ 5	384165	Angle, Mtg, Light	1
▲ 6	361339	Screw, Hex 6X 1.0 16 Pltd	2
▲ 7	10632-2	Grommet, Rubber	1
▲ 8	55248	Mount, Cable Tie	1
▲ 9	49266	Tie, Cable 1.75D Max 7.50Lg	1
▲ 10	383722	Circuitbreaker, 15Amp	1
▲ 11	360520	Switch, Rocker, Spdt, 3Pos	1

TENNANT COMPANY  
P. O. Box 1452  
Minneapolis, MN 55440-1452